



R30D

DC Operated, Light Weight RVDT

SPECIFICATIONS

- Bipolar DC operation
- ± 60 degree sensing range
- Light-weight
- Non-contact electrical design
- Wide operating temperature range
- Size 11 servo mount
- Anodized aluminum housing

The **R30D RVDT** (Rotary Variable Differential Transformer) is a DC operated non-contacting rotary position transducer. Integrated signal conditioning enables the R30D to operate from a bipolar ± 15 VDC supply, and provide a high level DC output that is proportional to the full angular sensing range of the device. Calibrated for operation over ± 30 degrees, the R30D provides a ± 3.75 VDC output, with a non-linearity of less than $\pm 0.25\%$ of full range. Extended range operation up to a maximum of ± 60 degrees is possible with increased non-linearity.

Internally, the DC supply voltage is converted into an AC carrier signal which excites the primary coil of the sensor. An integrated demodulator amplifier with low-pass filter converts the differential secondary output into a smooth, high level, linear DC output signal relative to the angular position of the shaft.

High reliability and performance are achieved through the use of a specially shaped rotor and wound coil that together simulates the linear displacement of a Linear Variable Differential Transformer (LVDT). Non-contact electromagnetic coupling of the rotor provides infinite resolution thus enabling absolute measurements to a fraction of a degree.

The R30D features a rugged aluminum size 11 housing making this rotary position sensor ideal for applications where integrated signal conditioning and small size are required.

FEATURES

- Extended operation up to $\pm 60^\circ$
- High level, low noise DC output
- Long term reliability
- Excellent temperature performance
- Rugged anodized aluminum housing
- Shielded ABEC 3 precision bearings

APPLICATIONS

- Hydraulic pump control
- Throttle lever position feedback
- Rotary actuator feedback
- Dancer arm position
- Reeler/Dereeler
- Valve position

PERFORMANCE SPECIFICATIONS

| ELECTRICAL SPECIFICATIONS | | | |
|----------------------------------|---|----------|----------|
| Angular range, degrees | ±30° (standard) | ±40° | ±60° |
| Non-linearity, % of FR, max. | ±0.25% | ±0.5% | ±2% |
| Output at range ends | ±3.75VDC | ±5.00VDC | ±7.50VDC |
| Sensitivity | 0.125 V/degree | | |
| Temp coefficient of sensitivity | 0.04%/°F [0.07%/°C], over operating temperature range | | |
| Input voltage | +/-15VDC ±10% | | |
| Input current | 25mA maximum | | |
| Output current | 5mA | | |
| Output impedance | 1 Ω maximum | | |
| Frequency response | 500Hz @ -3dB | | |

| ENVIRONMENTAL AND MECHANICAL SPECIFICATIONS | |
|--|--|
| Operating temperature | 0°F to +158°F [-18°C to 70°C] |
| Storage temperature | -67°F to +257°F [-55°C to 125°C] |
| Mechanical angular range | 360 degrees (no stops) |
| Bearings | Shielded ABEC 3 precision |
| Shaft diameter | 3/16 inch [4.76mm] |
| Housing material | Aluminum, anodized |
| Mounting | Size 11 servo mount BU-ORD |
| Moment of inertia | 0.53 x 10 ⁻⁶ inch.lb-force.second ² [0.61 x 10 ⁻⁶ Kg-force.cm.second ²] |
| Maximum torque, unbalance | 0.004 inch.ounce-force [0.3 gram-force.cm] |
| Maximum torque, friction | 0.015 inch.ounce-force [1.1 gram-force.cm] |
| Shaft load capability | 10 lb [4.5Kg] Axial; 8 lb [3.6 Kg] Radial |
| Electrical connection | 4 lead wires, 28AWG , PTFE insulation, 12 inches [30cm] long |
| Weight | 1.9 oz [54 grams] |
| IEC 60529 rating | IP60 |

Notes:

All values are nominal unless otherwise noted

FR (Full Range) is the angular range, end to end; 2xA° for ±A° angular range

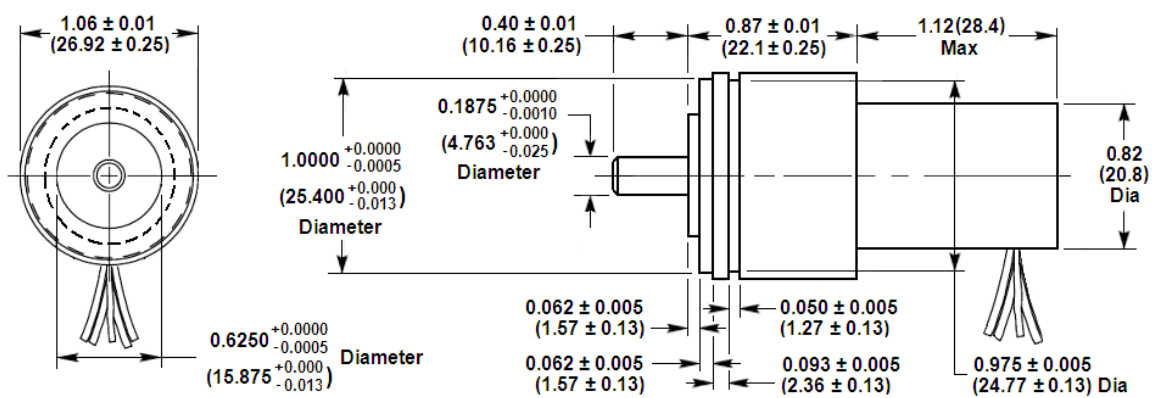
DIMENSIONS

Dimensions are in inch (mm)

R30D

DC Operated, Light Weight RVDT

WIRING INFORMATION

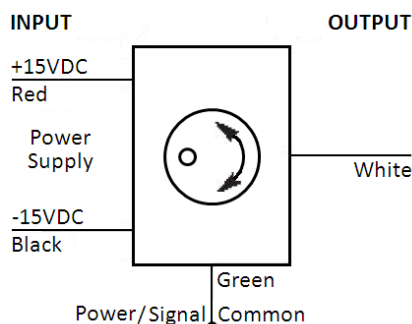

ORDERING INFORMATION

| Description | Model | Part Number |
|--|-----------|--------------|
| RVDT $\pm 30^\circ$ | R30D | 02560234-000 |
| OPTIONS | | |
| RVDT with $\pm 40^\circ$ calibration | R30D-040 | 02560234-040 |
| RVDT with $\pm 60^\circ$ calibration | R30D-060 | 02560234-060 |
| ACCESSORIES | | |
| R-FLEX multipurpose coupling kit | R-FLEX | 66530072-000 |
| Dual rail DC power supply ($\pm 15\text{VDC}$) | PSD 40-15 | 02291339-000 |

NORTH AMERICA

Measurement Specialties, Inc.,
a TE Connectivity Company
1000 Lucas Way
Hampton, VA 23666
United States
Phone: +1-800-745-8008
Fax: +1-757-766-4297
Email: sales@meas-spec.com

EUROPE

MEAS Deutschland GmbH(Europe)
a TE Connectivity Company
Hauert 13
D-44227 Dortmund
Germany
Phone: +49-(0)231-9740-0
Fax: +49-(0)231-9740-20
Email: info.de@meas-spec.com

ASIA

Measurement Specialties (China), Ltd.,
a TE Connectivity Company
No. 26 Langshan Road
Shenzhen High-Tech Park (North)
Nanshan District, Shenzhen 518057
China
Phone: +86-755-33305088
Fax: +86-755-33305099
Email: info.cn@meas-spec.com

TE.com/sensorsolutions

Measurement Specialties, Inc., a TE Connectivity company.

Accustar, American Sensor Technologies, AST, ATEXIS, DEUTSCH, IdentiCal, TruBlue, KPSI, Krystal Bond, Microfused, UltraStable, Measurement Specialties, MEAS, Schaevitz, TE Connectivity, TE, and the TE connectivity (logo) are trademarks of the TE Connectivity Ltd. family of companies. Other logos, product and company names mentioned herein may be trademarks of their respective owners.

The information given herein, including drawings, illustrations and schematics which are intended for illustration purposes only, is believed to be reliable. However, TE Connectivity makes no warranties as to its accuracy or completeness and disclaims any liability in connection with its use. TE Connectivity's obligations shall only be as set forth in TE Connectivity's Standard Terms and Conditions of Sale for this product and in no case will TE Connectivity be liable for any incidental, indirect or consequential damages arising out of the sale, resale, use or misuse of the product. Users of TE Connectivity products should make their own evaluation to determine the suitability of each such product for the specific application.

© 2015 TE Connectivity Ltd. family of companies All Rights Reserved.